

CK-U40MI/CI-126GS

0.4 MP 1/2.9" CMOS GigE Area Scan Camera



Introduction

CK-U40MI/CI-126GS camera adopts Sony® IMX297 sensor to provide high-quality images. It uses GigE interface to transmit non-compressed images in real time, and its max. frame rate can reach 126.5 fps in full resolution.

Key Feature

- Adopts low power consumption design with stable performance.
- Supports auto and manual adjustment of gain, exposure time, etc.
- Supports hardware trigger, software trigger, free run, etc.
- Adopts GigE interface and max. transmission distance of 100 meters without relay.
- Compatible with GigE Vision V2.0 Protocol, GenICam Standard, and third-party software based on the protocol and standard.

Dimension

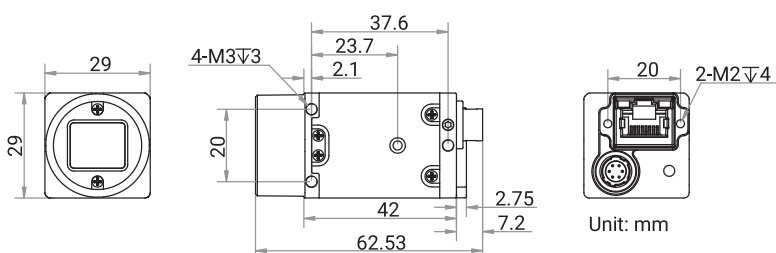

Available Model

- Mono camera: CK-U40MI-126GS
- Color camera: CK-U40CI-126GS

Applicable Industry

Electronics and semiconductor, factory automation, logistics and code reading, medicine package, etc.

Sensor Quantum Efficiency

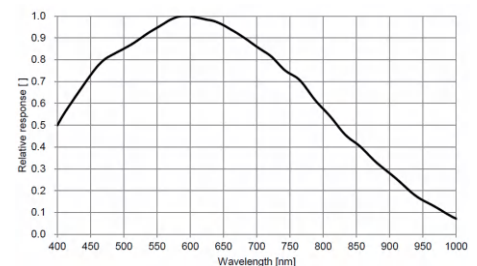

CK-U40MI-126GS

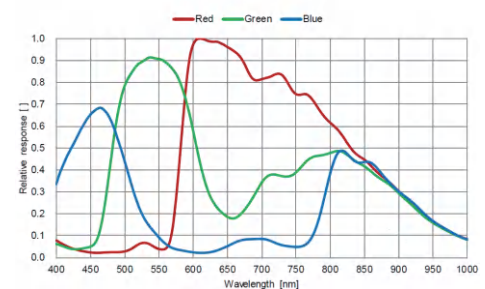

CK-U40CI-126GS

Specification

Model	CK-U40MI-126GS		CK-U40CI-126GS
Performance			
Sensor type	CMOS, global shutter		
Sensor model	Sony® IMX297		
Pixel size	6.9 μm × 6.9 μm		
Sensor size	1/2.9"		
Resolution	720 × 540		
Max. frame rate	126.5 fps @720 × 540 Mono 8	126.5 fps @720 × 540 Bayer RG 8	
Dynamic range	74 dB		
SNR	41 dB		
Gain	0 dB to 24 dB		
Exposure time	UltraShort exposure mode: 1 μs to 14 μs		
	Standard exposure mode: 15 μs to 10 sec		
Exposure mode	Off/Once/Continuous exposure mode		
Mono/color	Mono	Color	
Pixel format	Mono 8/10/10Packed/12/12Packed	Bayer RG 8/10/10Packed/12/12Packed	
Binning	Supports 1 × 1, 2 × 2, 4 × 4		
Decimation	Supports 1 × 1, 2 × 2, 4 × 4		
Reverse image	Supports horizontal and vertical reverse image output		
Electrical features			
Data interface	Gigabit Ethernet, compatible with Fast Ethernet		
Digital I/O	6-pin P7 connector provides power and I/O, including opto-isolated input × 1 (Line 0), opto-isolated output × 1 (Line 1), bi-directional non-isolated I/O × 1 (Line 2).		
Power supply	9 VDC to 24 VDC, PoE is optional		
Power consumption	Typ. 2 W@12 VDC		
Mechanical			
Lens mount	C-mount		
Dimension	29 mm × 29 mm × 42 mm (1.1" × 1.1" × 1.7")		
Weight	Approx. 100 g (0.2 lb.)		
Ingress protection	IP30 (under proper lens installation and wiring)		
Temperature	Working temperature: 0 °C to 50 °C (32 °F to 122 °F)		
	Storage temperature: -30 °C to 70 °C (-22 °F to 158 °F)		
Humidity	20% to 95% RH, non-condensing		
General			
Client software	CKVisionBuilder or third-party software meeting with GigE Vision Protocol		
Operating system	32/64-bit Windows XP/7/10, 32/64-bit Linux and 64-bit MacOS		
Compatibility	GigE Vision V2.0, GenICam		
Certification	CE, RoHS, KC		

