

# CK-SWWK04-110-230

## Specification

High-performance object-oriented telecentric lens

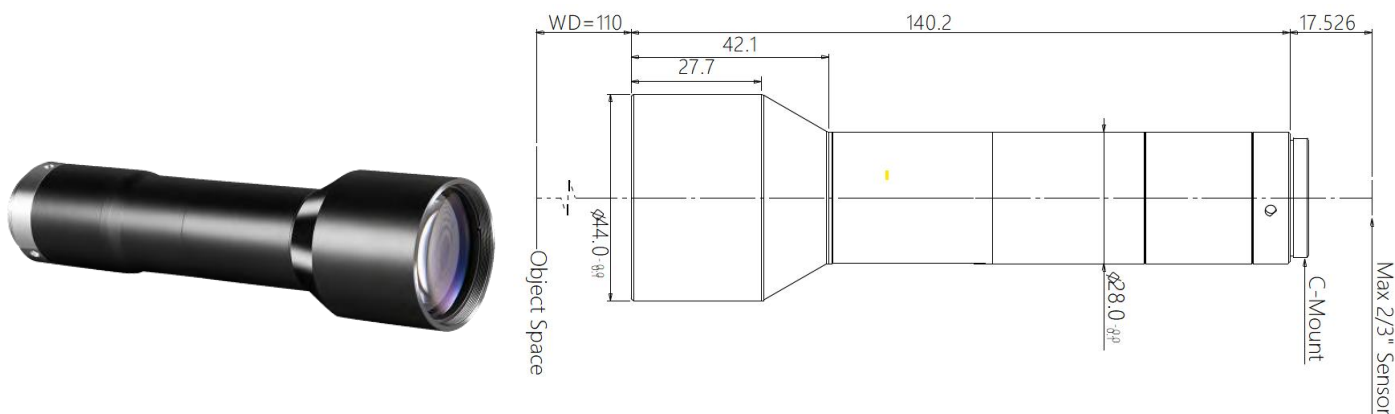

### Features

- Support high-resolution object-oriented telecentric lenses for 5M~20M pixel area scan cameras;
- A variety of low magnification designs to adapt to application scenarios with a larger field of view;
- High definition, low distortion, high telecentric, especially suitable for high-precision AOI and positioning applications;
- Long working distance specifications facilitate lighting and machine component layout;
- Built-in coaxial optical specifications are particularly suitable for wafers, glass devices, and display devices;
- Can be quickly customized to meet different camera specifications, as well as magnification, working distance, and depth of field requirements.

### Optical parameters

|                                  |              |
|----------------------------------|--------------|
| Magnification $\beta(x)$         | 0.4          |
| Working distance (mm)            | 110 $\pm$ 2  |
| CCD size ( $\Phi$ mm)            | 11(2/3")     |
| F/#                              | 7            |
| MTF30 (lp/mm)                    | >140         |
| Object Depth of Field DoF(mm)    | $\pm$ 1.8@F7 |
| Image distortion (% max)         | <0.02        |
| Telecentricity ( $^{\circ}$ max) | <0.03        |

### Mechanical parameters

|                           |       |
|---------------------------|-------|
| Camera interface          | C     |
| Overall lens length (mm)  | 140.2 |
| Whether the coaxial light | No    |

### Viewable range (mm x mm)

|                            |           |
|----------------------------|-----------|
| 1/1.8" EV76C570 (7.2x5.4)  | 18.0x13.5 |
| 1/1.7" IMX226 (7.5x5.6)    | 18.8x14.0 |
| 2/3" IMX250/264 (8.45x7.1) | 21.1x17.8 |