

# CK-H1200MU/CU-30.5GS

## 12 MP 1.1" CMOS USB 3.0 Area Scan Camera



### Introduction

CK-H1200MU/CU-30.5GS camera adopts Sony IMX304 sensor to provide high-quality images. It uses USB 3.0 interface to transmit non-compressed images in real time, and its max. frame rate can reach 30.5 fps in full resolution.

### Key Feature

- Supports LSC, Sequencer, passive transmission, Super Bayer, Super Palette, etc.
- Compact design with mounting holes on panels for flexible mounting from 4 sides.
- Supports hardware trigger, software trigger, free run, etc.
- Compatible with USB3 Vision Protocol, GenICam Standard, and the third-party software based on these protocol and standard.

### Dimension

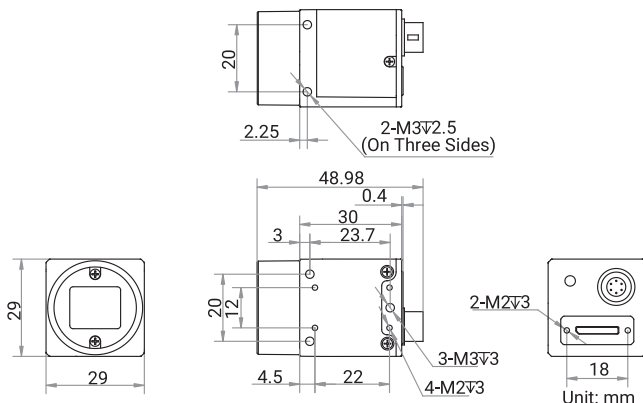

### Available Model

- Mono camera: CK-H1200MU-30.5GS
- Color camera: CK-H1200CU-30.5GS

### Applicable Industry

Electronic semiconductor, factory automation, liquor and beverage, medicine packing, screen AOI testing, etc.

### Sensor Quantum Efficiency

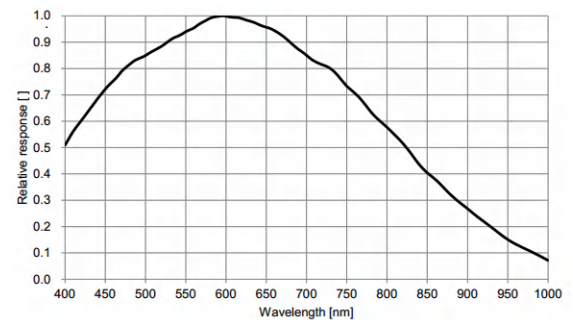

CK-H1200MU-30.5GS

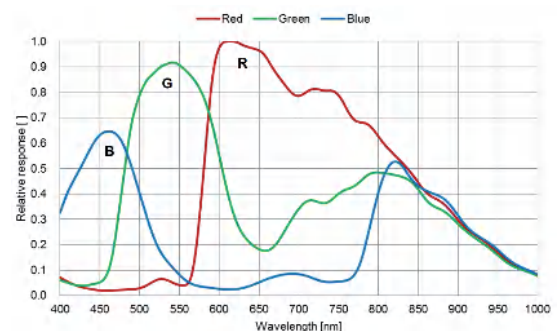

CK-H1200CU-30.5GS

# Specification

Model	CK-H1200MU-30.5GS	CK-H1200CU-30.5GS
<b>Performance</b>		
Sensor type	CMOS, global shutter	
Sensor model	Sony® IMX304	
Pixel size	3.45 μm × 3.45 μm	
Sensor size	1.1"	
Resolution	4096 × 3000	
Max. frame rate	30.5 fps @ 4096 × 3000 Mono 8	30.5 fps @ 4096 × 3000 Bayer RG 8
Dynamic range	72.2 dB	
SNR	40.2 dB	
Gain	0 dB to 24 dB	
Exposure time	UltraShort exposure mode: 2 μs to 14 μs	
	Standard exposure mode: 15 μs to 10 sec	
Exposure mode	Off/Once/Continuous exposure mode	
Mono/color	Mono	Color
Pixel format	Mono 8/10/12	
	Mono 8/10/10Packed/12/12Packed	Bayer RG 8/10/10Packed/12/12Packed YUV422Packed, YUV422_YUYV_Packed RGB 8, BGR 8
Binning	Supports 1 × 1, 2 × 2, 4 × 4	
Decimation	Supports 1 × 1, 2 × 2, 4 × 4	
Reverse image	Supports horizontal and vertical reverse image output	
<b>Electrical feature</b>		
Data interface	USB 3.0, compatible with USB 2.0	
Digital I/O	6-pin P7 connector provides power and I/O, including opto-isolated input × 1 (Line 0), opto-isolated output × 1 (Line 1), and bi-directional non-isolated I/O × 1 (Line 2).	
Power supply	9 VDC to 24 VDC, supports USB power supply	
Power consumption	Typ. 2.9 W @ 5 VDC (USB 3.0 provides power supply)	Typ. 3.2 W @ 5 VDC (USB 3.0 provides power supply)
<b>Mechanical</b>		
Lens mount	C-mount	
Dimension	29 mm × 29 mm × 30 mm (1.1" × 1.1" × 1.2")	
Weight	Approx. 80 g (0.2 lb.)	
Ingress protection	IP40 (under proper lens installation and wiring)	
Temperature	Working temperature: -10 °C to 50 °C (14 °F to 122 °F)	
	Storage temperature: -30 °C to 70 °C (-22 °F to 158 °F)	
Humidity	20% RH to 95% RH (no condensation)	
<b>General</b>		
Client software	CKVisionBuilder or third-party software meeting with USB3 Vision Protocol	
Operating system	32/64-bit Windows 7/10, 64-bit Windows 11, and 32/64-bit Linux	
Compatibility	USB3 Vision, GenICam	
Certification	CE, RoHS, KC	

